

KING'S CARRY-OUT
 6755 TAYLOR MILL ROAD WHITE'S TOWER
 PHONE—356-5747
 Beer - Party Supplies - Groceries

**SHERIFF'S OFFICE HOURS
 TAX COLLECTION**
 COVINGTON OFFICE: COURT HOUSE
 Monday thru Thursday 9:00 a. m. till 4:00 p. m.
 Friday 9:00 a. m. till 7:00 p. m.
 INDEPENDENCE COURT HOUSE
 Thursday 9:00 a. m. till 3:00 p. m.
 Saturday 9:00 a. m. till 12:00 noon
Joseph L. Nie, Sheriff
By Ed Schroeder, Chief Deputy

**ABSOLUTE
 AUCTION**
SATURDAY, OCTOBER 21 - 10:00 A. M.
 I have been instructed by Herman (Bud) Mann to sell all of their personal property, located 4 Miles East of Piner, Ky., 2 Miles from Fiskburg, 2 Miles West of Grassy Creek Store, on Kentucky Highway 17.
 1963 Chevrolet, low mileage; platform scales; anvil; log chains; roof paint; 3 bushels mixed grass seed; lot of horse-drawn tools; dehorners; 2 rolls woven wire; hydraulic jack; John Deere manure spreader; ropes; 13 sheets metal roofing; roof paint; gate; 2 wheelbarrows; 3 bath tubs; sled; 30 ft. extension ladder; woven wire stretchers; 70 bales hay; lot of small tools; metal safe.
 ANTIQUES: Several rockers; odd chairs; 3 5-gallon cream cans; oil lamps; 2 Aladdin lamps; kitchen lamp with reflector; organ; high chair; picture frames; coffee grinder; cherry chest of drawers; several antique dishes and bowls; gas refrigerator.
 Lot of cooking utensils, and other things too numerous to mention.
 TERMS: CASH! LUNCH SERVED!
MR. HERMAN MANN, OWNER
Carl Lancaster, Auctioneer - 654-4421
 Falmouth, Kentucky
FELIX WADE, Apprentice Auctioneer

**COUNTY
 AGENT'S
 1/2 ACRE**
 —by—
JOE CLAXON



Cooler weather may mean new insect problems for the Kentucky home. This season is just around the corner and it may cause such pests as cluster flies, crickets, ants, spiders, millipedes, cockroaches, etc., to seek shelter, and these pests may happen upon our cozy homes and decide to settle in for the winter. Let's now allow this invasion of our privacy.

We can establish a good residual barrier against the creepy crawlers by spraying the inner and outer foundation walls of our homes with a 2 percent chlordane mixture. This will provide continuing protection.

Application of this spray before the exodus begins, can pay dividends on those cold winter afternoons when we are inclined to settle back with a good book, watch football or tinker in the workshop. Believe me, it is easier to treat now than when the thermometer is hovering around 20 degrees.

A specific pest that caused quite a lot of headaches this year is the cluster fly, rather sluggish in its movements and produces an annoying loud buzzing sound. With the approach of cool weather, a large number of adult flies may collect on the sides of dwellings and quickly find their way into attics through cracks, unscreened vents and louvers. On warm winter days they will become active and can often be heard buzzing in the walls. Sometimes they are attracted by light into the living areas of the house. Cluster flies are pests only in the sense that they are annoying.

The best solution to the cluster fly problem is to prevent their entrance into the home by good screening. If this is impractical or if they have already entered, control can be achieved by treat-

IN LOVING MEMORY . . .
 In memory of "Our Mom."
 Though we cannot feel the touch of your hand, see the warmth in your eyes, hear your happy laughter and touch your cheek with ours; how very much we miss your love, understanding, and guidance that you always gave to us. From your gift of love, honesty and pride, we have been strengthened to endure any distress that we may face in our span of life. Your loving memory will dwell in our hearts and minds forever. Sadly missed by
 THE CHILDREN OF
MRS. BESSIE ELMORE
 14-42c

ing the attic area. Use one of the following control practices: (1) hang 20 percent dichlorvos (Vapona, DDVP) resin strips in the attic at the rate of one per every 1,000 cubic feet; (2) apply a five percent malathion spray to rafters and other areas where clustered (3) for a quick knockdown of the flies that enter the living quarters use an aerosol bomb containing

pyrethrins. Spray must hit flies to be effective.
 How come it's a nice cup of tea but a good cup of coffee?

Generally the hay fever season reaches its peak between August 15 and September 15. However, in some areas it lasts until November.

THE BIBLE SPEAKS
 International Union
 Sunday School Lessons
BY LAWRENCE W. ALTHOUSE

LOVE THY NEIGHBOR
 Lesson for October 22, 1972

Background Scripture: Genesis 1:26-27; Luke 10:25-37; Ephesians 2:11-18; Colossians 3:1-11; James 2:1-4.
 Devotional Reading: Acts 10:34-43.

It's a lot easier to say than do! Jesus said it: "... you shall love . . . your neighbor as yourself" (Luke 10:27). Of course, he not only said it, he did it and the cross is our constant reminder of that.

Yet, we have trouble trying to comply with this gentle command. The problem is that our neighbor often is not very lovable. In fact, he may bedownright despicable. So how do you love someone you can hardly stand? What can you do with your feelings like that about someone?
Rev. Althouse

Feelings follow behaviour
 Recently I heard a psychologist, Dr. William Parker, say: "Feelings follow behaviour." I knew what he meant for I too had discovered this principle, particularly in attempting to fulfill Christ's command to love my neighbor. Jesus, I had come to realize, did not say "feel love" for your neighbor. The "love" of which Jesus spoke has a much more active dynamic than mere "feeling" or "emotion."

In one of his books, Keith Miller tells us of his struggle to understand the meaning of Christ's command to love. One day, in his imagination, he sees his little girl about to be run over by a large truck. Continuing the imaginary scene, he sees himself sacrifice his own life in order to push his daughter to safety. This was clearly a sacrificial act of love.

Then, however, he saw another child, a "nasty little kid," from next door also about to be crushed by a truck. Although he did not even like this obnoxious child, in his imagination he found himself doing exactly as he had imagined himself doing with his own daughter and at the cost of his own life.

Show no partiality
 James, in his epistle, says: "My brethren, show no partiality . . ." (James 2:1). Note that he says "show" not "feel." One cannot help feeling partial toward those who are attractive to us and often we feel more gracious to the affluent person than the poor. Yet, regardless of what we may feel, he says, do not practice partiality. We cannot always manage our feelings toward people, particularly towards those who are strange and different. It was not necessary that Jesus felt loving while he hung on the cross, but that he do something loving for us. Loving my neighbor is easier to say than do and doing it is easier than feeling it. But if we do it, regardless how we feel, in time we may also come to feel it as well.

A & R Refrigeration & Air Conditioning
 Any Type Cooler - Commercial & Industrial
 —MILK COOLER SPECIALTY—
 Phone 1-606-567-4291
ROY BEHYMER
 ROUTE 2 SPARTA, KY.

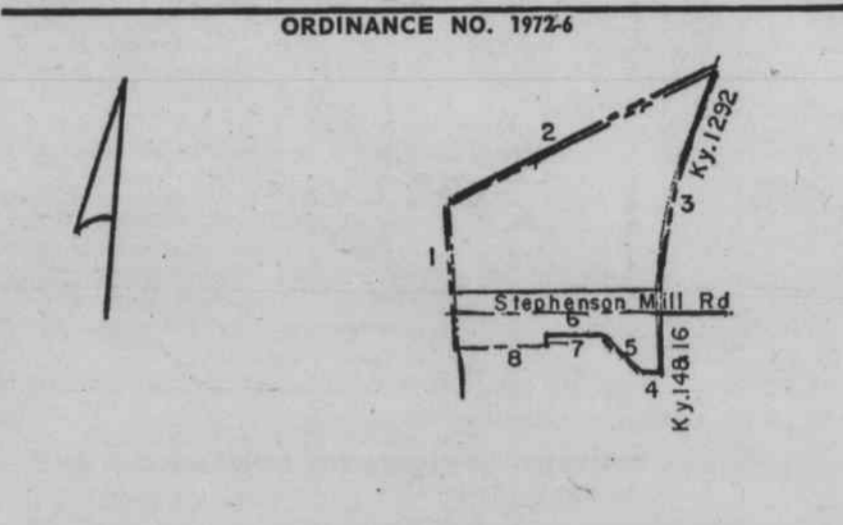

PROPOSED CITY OF WALTON ANNEXATION
 SEPTEMBER 1, 1972 SCALE 1"=400'

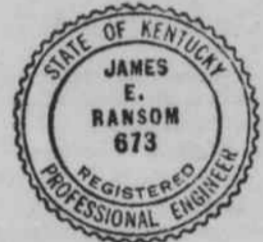

An Ordinance proposing to annex to and make part of the incorporated territory of the City of Walton, Kentucky, (a fifth class city) certain unincorporated territory contiguous to the existing Northwest Corporate Limits of the City of Walton, Kentucky.

WHEREAS, the City Council of the City of Walton, Kentucky, deems it to be for the best interests of the Citizens of the City of Walton and for the best interests of persons residing in certain unincorporated territory, said territory being contiguous to the present City Limits on the Northwest corporate limits of the City of Walton, Kentucky, that said territory be annexed to and become part of the corporate territory of the City of Walton, Kentucky.

NOW, THEREFORE, BE IT ORDAINED BY THE CITY COUNCIL OF THE CITY OF WALTON, KENTUCKY.

SECTION 1—That it is hereby proposed that the hereinafter described unincorporated territory lying to the Northwest of and being contiguous to the present corporate limits of the City of Walton, Kentucky, be annexed to and made a part of the corporate territory of the City of Walton, Kentucky.

SECTION 2—Said territory hereby proposed to be annexed is bounded and described as follows, to-wit:
 Being contiguous to the existing City Limits on the Northwest the City of Walton, Kentucky, proposes to annex the following:

BEGINNING at a point in the existing City Limits said point being in the South right of way line of Stephenson Mill Road approximately 520 feet West of its intersection with Kentucky 14 and 16; thence (1) N 9 - 20 W 378 feet; thence (2) N 57 - 12 E 628 feet, more or less, to Kentucky Highway 1292; thence (3) Southwesterly with said Highway 780 feet, more or less, to the existing City Limits; thence (4) Southwesterly 40 feet, more or less; thence (5) Northwesterly 140 feet, more or less; thence (6) Southwesterly 150 feet, more or less; thence (7) Southeasterly 30 feet, more or less; thence (8) Southwesterly 240 feet, more or less, to the beginning.

The plat of the above described territory is incorporated herein by reference, and is appended hereto and made a part hereof.

SECTION 3—It is hereby ordered that this ordinance together with a plat of the territory herein described be published in at least four (4) issues of the WALTON ADVERTISER, Walton, Kentucky, on each of four (4) separate weekly publications of said newspaper, and that copies of this ordinance be posted at least twenty (20) days in four (4) of the most public places in the City of Walton, Kentucky.

SECTION 4—If, after the aforesaid publication and posting has been done and made and no petition protesting the annexation of the territory herein described, has been filed in the Boone Circuit Court, the City of Walton, Kentucky, hereby proposed to enact another ordinance annexing to the City of Walton, Kentucky, the above described unincorporated territory shall become a part of the City of Walton, Kentucky.

SECTION 5—All ordinances, resolutions or parts thereof, in conflict herewith, are to the extent of such conflict, hereby repealed.

SECTION 6—If any paragraph, section, or clause of this ordinance be held by a proper court to be invalid, such invalidity shall not affect the remaining sections, paragraphs, or clauses, it being expressly declared that the remainder of said ordinance would have been passed despite such invalidity.

PASSED, APPROVED ON FIRST READING, this the 12th day of September, 1972, by a vote of five members of the City Council of the City of Walton, Kentucky.

PASSED, APPROVED ON SECOND READING, this the 10th day of October, 1972, by a vote of six members of the City Council of the City of Walton, Kentucky.

APPROVED: DALLAS M. JUSTICE, Mayor
 ATTEST: DAISY HILL, Clerk (Pub. Oct. 19-26; Nov. 2-9)

**Mobile Home
 SALE OF THE YEAR
 NOW!!!**
Low Down Payment! On The Spot Financing!
 NEW AND USED! BEST SELECTION EVER!
Choice Lots Available.....At \$42.50 Per Month
 PLUS THESE NO-COST EXTRAS: Free water, sewer and garbage pickup, plus new fiberglass skirting completely installed with each purchase. Paved streets, 2-car offstreet parking. LAUNDROMAT and PLAY AREA. Ideal location, just 10 miles from downtown Cincinnati.
PARKER-SMITH
MOBILE HOMES PARK & SALES OFFICE
 1150 EDWARDS ROAD ELSMERE, KENTUCKY
 For Additional Information—Call 331-0034
 —Open 7 Days A Week From 9:00 A. M. Until Dark—

**Stith
 funeral home inc.**

 Parking For 75 Cars - Air Conditioned
Dial 371-0333
 DON STITH — A. C. (TICK) SHIELDS
 WE SERVICE ALL BURIAL POLICIES
 7500 U.S. Hwy. 42 Florence, Ky.