

## STAFF REPORT

REQUEST OF CORPOREX PARKS OF KENTUCKY, INC. FOR A  
CHANGE IN CONCEPT DEVELOPMENT PLAN FOR PART OF LOT ONE,  
CIRCLEPORT I SUBDIVISION, BOONE COUNTY, KENTUCKY

FEBRUARY 24, 1988

Applicant is requesting approval of a Change in a Concept Development Plan for part of Lot One, Circleport I Subdivision. The 4.6 acre site is presently zoned Industrial One (I-1) and is located at the northwest corner of Circleport Boulevard and Mineola Park, Boone County, Kentucky.

History of the Site

The Circleport I Subdivision contains approximately 75 acres located at the northwest corner of Mineola Pike and I-275. The following is a brief history of previous zoning actions on the 75 acre tract:

- 1981 - A zone change from Suburban Residential One (SR-1) to Industrial One (I-1) and Concept Development Plan were approved March 18 and April 9 by the Planning Commission and Fiscal Court respectively. Two conditions of this zone change were that the applicant dedicate additional right-of-way for widening of Mineola Pike and provide a 50 foot wide green belt or buffer area adjacent to the future Mineola Pike right-of-way, for the purpose of screening from residences south of Mineola Pike.
- 1982 - On May 26 a Public Hearing was held to consider a change in the Concept Development Plan to extend Circleport Boulevard for a connection with Mineola Pike near I-275. This request was indefinitely deferred at the applicant's request on June 2.
- 1985 - The Planning Commission, after another Public Hearing (December 18), approved a change in the Concept Development Plan to extend Circleport Boulevard for a second connection with Mineola Pike.
- 1986 - On August 27, the Planning Commission held a Public Hearing on the applicant's request for a Zone Change for I-1 to Industrial One/Planned Development Overlay (I-1/PD) for 32.5 acres of the subdivision nearest I-275. The Commission approved this request on September 17, and the Fiscal Court approved it on October 21.

Facts regarding the previous zoning actions, as they directly affect the subject 4.6 acre site, are as follows:

1. Lot Size - The original (1981) Concept Development Plan designated lot number one as an 8.5 acre lot;

2. Previous Development - One June 18, 1986, the Planning Commission approved a Site Plan for development of an office, manufacturing, and warehouse building for the northern 4.1 acres of Lot One;
3. Landscaping/Buffering - The 50 foot wide buffer zone is required along Mineola Pike, and a 30 foot wide buffer zone is required along the west property line of the site abutting a residential (SR-1) zone.

#### Surrounding Land Use and Zoning

South of the site, on the opposite side of Mineola Pike, is The Gap warehouse and distribution facility in an I-1 zone. This facility, while it has greatly expanded in recent months, was present in 1981.

North and east of the site is the remainder of the Circleport I Subdivision (zoned I-1 and I-1/PD). Located on the northern half of Lot One is the Tressa office, manufacturing, and warehouse facility.

West of the site is a single-family residence in the SR-1 zone. Located southeast of the site, along the south side of Mineola Pike, are several single-family residences in the Rural Suburban (RS) zoning district.

#### Public Facilities and Existing Features of the Site

The 4.6 acre site is presently undeveloped; however, several physical improvements have been constructed. There are presently storm sewer and sanitary sewer facilities located on site which connect to existing facilities that serve the entire subdivision.

Earthen berms have been constructed along the east side of the site near Circleport Boulevard. The western portion of the site is wooded with relatively mature trees.

In addition, the site is partially within the clear zone of the airport's major east-west runway, and is within the most recently proposed 70 LDN noise contour for 1990.

#### Relationship to the Comprehensive Plan

The proposed Concept Development Plan must be reviewed in relation to the 1986 Boone County Comprehensive Plan. The area is referred to in a number of ways:

Future Land Use Map - Industrial

Land Use Element - Latonia Area

"The proposed interchange with its proximity to the airport is ideal for airport-related industrial activity. Unfortunately though, the existing residences on Mineola Road will encounter increasing pressures to relocate. The residential area encompassed by Donaldson Road, I-275, and Mineola Pike will not have the same market forces placed on it and should in fact remain to provide close residential development for airport employees. New residential growth within the airport's clear zone should be discouraged. Eventually, the industrial development within the Mineola Park will merge with the development moving south from the Mineola Interchange." (page L-18)

Business Activity Element -

"To the east of the airport, the Mineola-Circleport-KY 236 area will be an area of great industrial growth in the county. High-tech industry and airport related services should be encouraged at the I-275 Interchanges and in the runway clear zones and north of the airport. This should include the future clear zone for the proposed new North-South runway. These areas have locational advantages for industry because of proximity to air and truck transportation." (pages B-15,16)

In addition, the Goals and Objectives of the Comprehensive Plan state:

"Compact, efficient development patterns shall be encouraged for commercial and industrial development by maintaining buffer space between uses." (page G-3)

"Amenity for industrial uses and a favorable relationship for adjoining uses should be fostered by means of design. Industrial nuisances such as smoke, dust, noise, and odor should be controlled." (page G-4)

Proposed Concept Development Plan

The proposed Concept Development Plan for the 4.6 acre site indicates a 64,640 square foot facility of unspecified use. The major change from the current Concept Development Plan is the placement of automobile parking in the 50 foot buffer zone adjacent to Mineola Pike. The proposed plan indicates a six foot wide hedgegrow planted between the proposed parking area and the Mineola Pike right-of-way. The existing earth berms are proposed to be retained at this time; however, the plan indicates that the berm closest to Mineola Pike may be replaced with parking at some future date.

Staff Concerns

1. Lot Split:

The original Concept Development Plan indicates Lot One to be an 8.5 acre site with the 50 foot landscaped buffer along Mineola Pike. Subsequent to the approval of the current Concept Plan, the applicant has split Lot One into two lots and developed a portion of the lot. Consequently, the remaining buildable portion of the lot has been reduced.

2. Adjacent Industrial Use:

The basis for requirement of the 50 foot buffer zone was protection of residential uses on the south side of Mineola Pike. The existing use of property directly south of the subject site is industrial/warehouse; however, this use was present in 1981.

3. Proposed Yew Hedge:

Section 1817 of the Zoning Regulations requires screening of parking areas adjacent to public streets. The adequacy of the proposed yew hedge should be examined with regard to this requirement. In addition, the proposed removal of one of the existing berms should be examined for its impact on residential uses southeast of the site.

4. Use of Site:

While the property is presently zoned for light industrial uses, the proposed plan does not specify the intended use of the subject site.

Conclusion

The revised Concept Development Plan should be reviewed on the basis of its potential impact upon existing residential uses in the vicinity, the concerns listed above, and its relationship to the Boone County Comprehensive Plan. If the Planning Commission and Boone County Fiscal Court were to approve this request, the Boone County Comprehensive Plan would not need to be amended.



---

Jim Sturdevant,  
Plans Examiner/Planner

**CIRCLEPORT I LOT I  
REVISED CONCEPT PLAN**

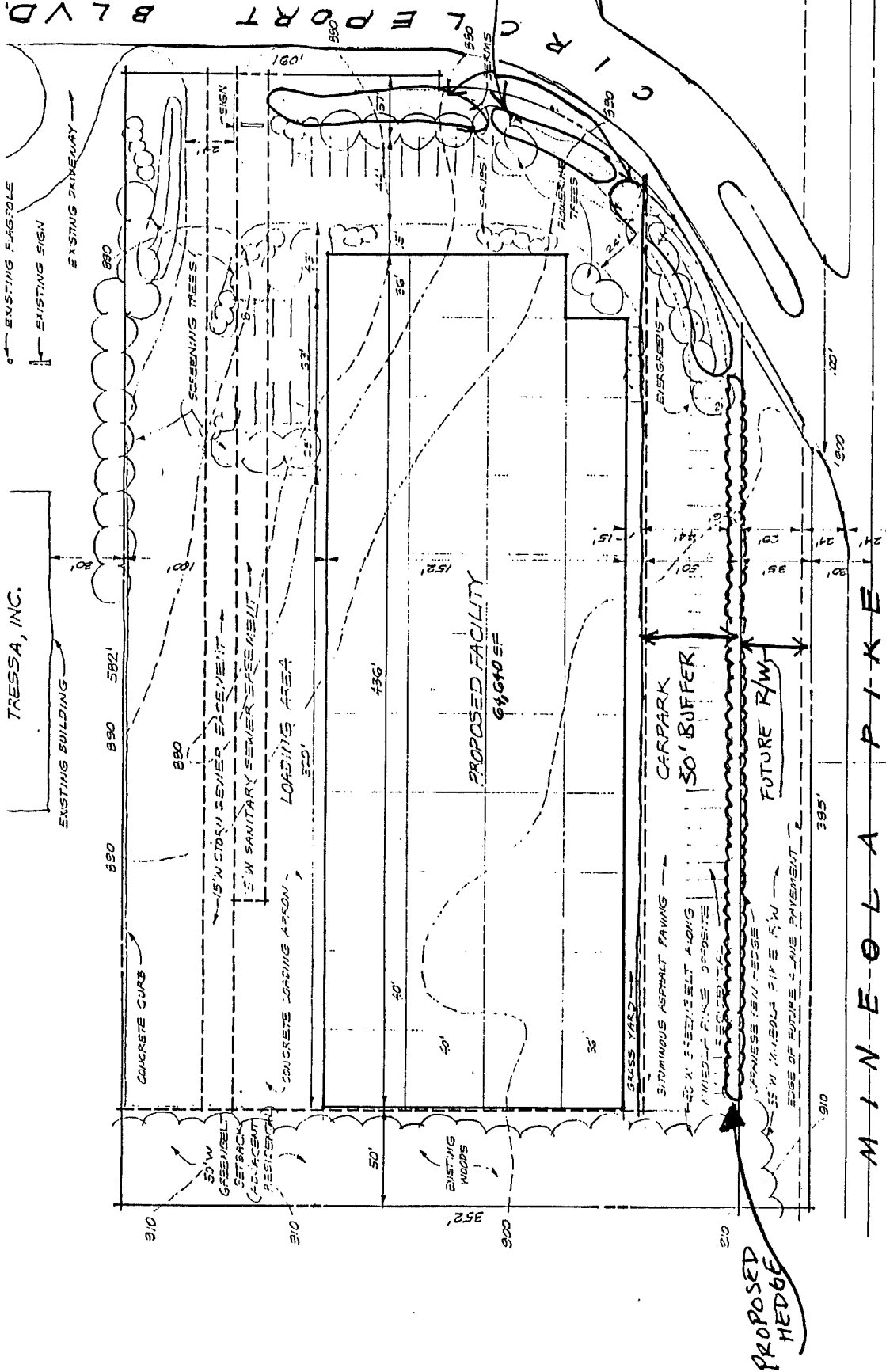

**ZONING: ZONED F-1**  
 50' MAX. BLDG. HGT.  
 50' FRONT YARD  
 50' REAR YARD  
 50' SIDE YARD  
 10' SIDE YARD

**SITE DATA: 1.60 ACRES**  
 64,640 SF SERVICE BLDG  
 58 PARKING SPACES BLDG  
 11 FUTURE PARKING SPACES  
 100' X 320' LOADING DOCK  
 25' W ACCESS DRIVE  
 25' W BUILDING EAVE HEIGHT  
 GAS, WATER, SEWER, ELECTRIC AVAIL.

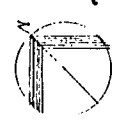

THE GAP

**CONCEPT SITE PLAN 1" = 50' 0"**  
 2080-P 22 MAY 88 A/H

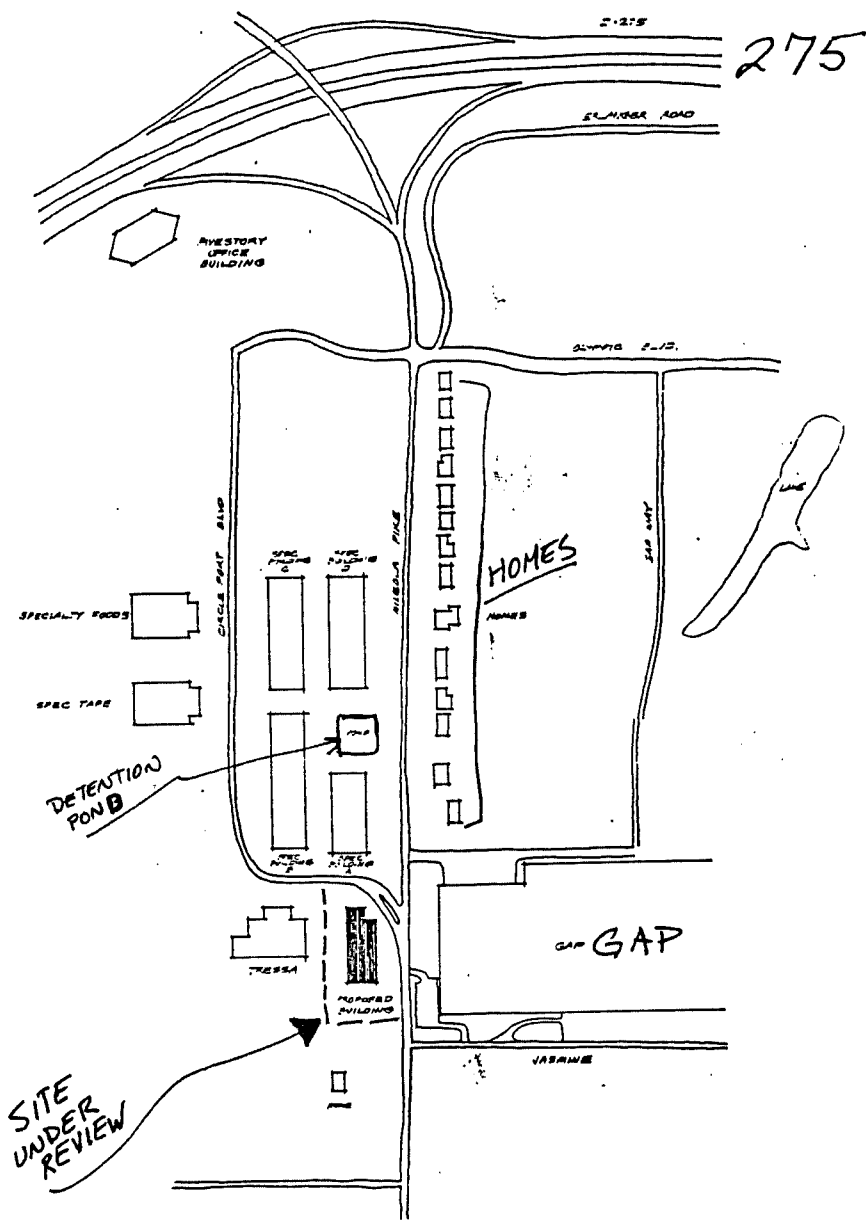

VICINITY MAP <sup>ATS</sup>  
 2-24-88



PROPOSED OFFICE/SERVICE BUILDING FOR  
CORPORTEX

TO BE LOCATED IN THE SOUTH WEST CORNER OF MIRCOLA AND CIRCLEPORT  
 23 FEB 88 CORP-P AJH

APPLICATION FOR ZONING ACTION

TO:

- Boone County Planning Commission
- City of Florence Board of Adjustment
- Boone County Board of Adjustment
- City of Union Board of Adjustment
- City of Walton Board of Adjustment
- Zoning Enforcement Officer

FOR:

- Zoning Text Amendment
- Comprehensive Plan Change
- Preliminary Plat Review
- Conditional Use Permit
- Concept Development Plan Change
- Preliminary Development Plan
- Change of Non-Conforming Use
- Design Review Board and Certificate of Appropriateness
- Zoning Map Amendment
- Planned Development Overlay Change
- Improvement Plat Review
- Final or Deed Plat Review
- Site Plan Review
- Historic District Overlay
- Appeal or Variance
- Sign or Zoning Permit

Applicant: Corporex Parks of Kentucky, Inc.  Owner  Agent  
 Address: 1717 Dixie Highway, Ft. Wright, Kentucky 41011  
 Telephone: (606)331-5000

Location: Lot #1 - CirclePort I

Name of Property Owner: Corporex Parks of Kentucky, Inc.

Address of Property Owner: 1717 Dixie Highway, Ft. Wright, Kentucky 41011

Zoning District: I-1 Area in Acres: 4.3

Deed Book: See Attachment Page Number: \_\_\_\_\_ Group Number: \_\_\_\_\_

Description of Request: Allow parking in land previously designated as a screening area, in areas adjacent to an industrial use.

Applicant's Signature: Thomas Banta

Property Owner's Signature: Thomas Banta

Application Fee: \$394.20 FOR PLANNING COMMISSION USE ONLY Date Received: 2/3/88 By: K. Costello

Referred To: for Meeting Date: 2/24/88 Public Hearing

Action Taken: Recommended Approval Date of Action: 3/2/88

EXHIBIT "A"

J. W. BERLING  
ENGINEERING COMPANY



*Land Surveying, Site Development, Civil Engineering Services*  
Ky. Registration No. 6745 • Land Surveyor Registration Ky. 208

606/291-2680  
1132 MAIN STREET  
COVINGTON, KY 41011

February 8, 1988

LEGAL DESCRIPTION  
PART OF LOT NO. 1  
CIRCLEPORT ONE SUBDIVISION

Beginning at a point in the northwest line of Mineola Pike, said point being the south corner of Lot No. 1 of Section No. 1 of Circleport One Subdivision; thence with the southwest line of said Lot No. 1, N 39<sup>o</sup>-32'-27" W 351.87 feet to a point; thence through Lot No. 1, N 50<sup>o</sup>-43'-19" E 577.30 feet to a point in the southwest line of Circleport Drive; thence along same in a southwesterly direction 440.58 feet to a point in the northwest line of Mineola Pike; thence along the northwest line of Mineola Pike S 49<sup>o</sup>-43'-13" W 384.38 feet to the place of beginning.

CONTAINING 4.3019 ACRES.

N O T I C E  
P U B L I C   H E A R I N G

The Boone County Planning Commission will hold a Public Hearing regarding a request for a change in a previously approved Concept Development Plan by Corporex Parks of Kentucky, Inc., for certain real estate owned by Corporex Parks of Kentucky, Inc. The present zoning of the subject property is Industrial One (I-1) subject to a Concept Development Plan approved by the Boone County Fiscal Court April 7, 1981. The Public Hearing is to be held February 24, 1988 at 7:00 p.m., in the third floor auditorium of the Boone County Administration Building, Burlington, Kentucky.

The real estate for which Change in Concept Development Plan is requested is a portion of Lot One, Circleport I Subdivision, located at the northwest corner of Mineola Pike and Circleport Boulevard, Boone County, Kentucky. The legal description for this property is represented as a part of or the complete tract as recorded in DEED BOOK 280, PAGES 85, 91, and 93, DEED BOOK 293, PAGE 167, and DEED BOOK 322, PAGE 296, of the Boone County Clerk's Office, as supplied by the applicant for this application. This Public Hearing is to serve as a due process, trial type hearing where all persons may be heard regarding this request.

The Boone County Comprehensive Plan, including its Land Use Plan Map, will be reviewed to determine whether the map amendment, if approved, would be consistent with the Comprehensive Plan. If such a request would be inconsistent with the Comprehensive Plan, then any changes to the Comprehensive Plan to make it consistent with the request, if approved, will be reviewed.

All interested persons are encouraged to attend and be heard.

(For publication in the Boone County Recorder, 2/11/88)

EXHIBIT "B"

BOONE COUNTY PLANNING COMMISSION

Public Hearing Item #4  
February 24, 1988

Page 1

Chairman Viox opened the Public Hearing for the next item on the Agenda:

4. Applicant: Corporex Parks of Kentucky, Inc. (owner)  
Request: Revision of a Concept Development Plan

This was a Public Hearing on a request of Corporex Parks of Kentucky, Inc. (owner) for a Revision of a previously approved Concept Development Plan on a 4.3-acre site located at Lot 1, Circleport I, off Mineola Pike, Boone County, Kentucky. The current zoning of the site is Industrial One (I-1).

Staff Member, Jim Sturdevant, presented the Staff Report which included a slide presentation (see Staff Report).

Chairman Viox asked the applicant for his comments.

Mr. Tom Banta, representing Corporex, stated that in 1981 a 50' greenbelt was required along with 35' for road widening. The 50' greenbelt was an existing roadway with trees. They have been dividing up the property and selling it. He stated that Lot #1 is restricted by the road widening and the greenbelt and is directly across the street from an industrial zone. He stated that they are being required to have a 50' greenbelt between two industrial uses in this location. They have created a berm along Mineola Pike and are proposing to construct a building. He noted the location on a drawing of a 15' stormwater easement and a 15' sanitary sewer easement. They are proposing the truck parking are on top of the easements with the building and additional parking in front. They will add additional landscaping along the front portion.

Chairman Viox asked if there was anyone else present who wished to speak in behalf of the request. There being no response, he asked if there was anyone present in opposition to the request or if there were any questions. There being none, he asked Mr. Sturdevant to complete the Staff Report at this time.

Mr. Sturdevant completed the Staff Report noting the Staff's concerns regarding this request.

Chairman Viox asked if there were any questions or comments from the Commission.

Mr. DeLong questioned what the use of the site would be.

Mr. Banta stated that he would like to respond to the Staff's concerns. He noted that the requirements for the 175-acre tract do not make as much sense when applied to this 4-acre parcel that is across the street from an industrial use. He stated that the hedgerow was put in to make the site more attractive and there are some spot elevations on the site. Headlights will not be a problem in consideration of the elevation and as the road is about ten feet

from the parking lot. In response to Mr. DeLong's question, he stated that a distribution company is interested in the site and they will lease the building as a warehouse/distribution facility.

Chairman Viox asked if there were any further comments or questions. There being none, he stated that this item will be on the agenda for the Business Meeting on March 2, 1988 at 8 P.M. and closed this Public Hearing.

APPROVED:

  
\_\_\_\_\_  
William Viox, Chairman

ATTEST:

  
\_\_\_\_\_  
Jan Hancock, Recording Secretary

BOONE COUNTY PLANNING COMMISSION

BUSINESS MEETING

March 2, 1988

8:00 P.M.

---

---

Mr. William Viox, Chairman, called the meeting to order at 8:00 P.M..

COMMISSION MEMBERS PRESENT:

Mr. Larry Barnett, Vice Chairman  
Mr. Fred Burch  
Mrs. Rita Bushelman  
Mr. Lawrence Collins  
Mr. Phil Damstrom  
Mr. Melvin DeLong  
Mr. Rector Jones  
Mr. Don McMillian  
Mr. Charles Moore  
Mr. Barry Neltner  
Mr. Ralph Rush  
Mr. Floyd Sharp  
Mrs. Carol Smith  
Mr. William Viox, Chairman

COMMISSION MEMBERS NOT PRESENT:

Mr. R. N. Greene

LEGAL COUNSEL PRESENT:

Mr. Dale Wilson

Chairman Viox noted that each member had received a copy of the Minutes of the Business Meeting of February 17, 1988 and the Public Hearings of February 24, 1988 and asked if there were any comments or corrections.

There being no changes to the Minutes, Mr. Barnett moved that the Minutes of the Business Meeting of February 17, 1988 and the Public Hearings of February 24, 1988 be approved as mailed. Mr. McMillian seconded the motion and it carried unanimously.

Mr. Gerald Newton, Director, read the Committee Report which recommended approval based on the finding of fact, but subject to one condition (see Committee Report).

Chairman Viox asked if there was a representative of the applicant present.

Mr. Ray Erpenbeck stated that they are in agreement with the condition.

Chairman Viox asked if there was anyone present who wished to speak in regard to this request.

There being no response, Mr. Collins moved by resolution to the Fiscal Court that the request be approved as recommended by the Committee Report, based on the finding of fact, and subject to the condition. Mr. Burch seconded the motion and it carried unanimously.

### 3. Revision of a Concept Development Plan

A request of Corporex Parks of Kentucky, Inc. (owner) for a Revision of a previously approved Concept Development Plan on a 4.3-acre site located at Lot 1, Circleport I, off Mineola Pike, Boone County, Kentucky. The current zoning of the site is Industrial One (I-1).

Mr. Gerald Newton, Director, read the Committee Report which recommended approval based on the findings of fact, but subject to conditions (see Committee Report).

Chairman Viox asked if there was a representative of the applicant present.

Mr. Tom Banta stated that they are in agreement with the conditions.

Chairman Viox asked if there was anyone else present who wished to speak.

There being no response, Mr. Burch moved by resolution to the Fiscal Court that the request be approved as recommended by the Committee Report, based on the findings of fact and subject to the conditions. Mr. DeLong seconded the motion and it carried unanimously.

### 4. Zoning Map Amendment

A request of John Cummins (dba Insurance Distribution Center) for Richard Ammon and Robert Maddox (owners) for a Zoning Map Amendment for a 7-acre (approx.) parcel located at 1840 Florence Pike, Boone County, Kentucky. The request is to rezone the property from Commercial Two (C-2) to Commercial Services (C-3) to allow the sale of pre-owned automobiles.

Mr. Gerald Newton, Director, read the Committee Report which recommended denial of the request based on the findings of fact (see Committee Report).

EXHIBIT "C"

COMMITTEE REPORT

TO: Boone County Planning Commission

FROM: Carol Smith, Chairwoman

RE: Request of Corporex Parks of Kentucky, Inc.  
(owner) for a Revision of a previously approved  
Concept Development Plan on a 4.3 acre site  
located at Lot 1, Circleport I, off Mineola Pike,  
Boone County, Kentucky. The current zoning of the  
site is Industrial One (I-1).

DATE: March 2, 1988

REMARKS:

We, the Committee, recommend approval of the Change in Concept Development Plan based upon the following findings of fact and with the following conditions:

Findings of Fact:

1. The proposed Concept Development Plan is in conformance with the 1986 Boone County Comprehensive Plan, Future Land Use Map, which indicates future land use of industrial for the subject property;
2. The proposed Concept Development Plan, if developed in conformance with the conditions listed below, is in conformance with the Goals and Objectives of the Comprehensive Plan (pages G-3 and G-4) as further detailed in the February 24, 1988 Staff Report. In summary, the Committee believes the provision of the landscaped berms along Circleport Boulevard provides more effective screening for the residential uses along Mineola Pike than would the previously required green belt area opposite THE GAP facility.

Conditions:

The Applicant is being asked to agree to include these items as part of the Concept Development Plan in order to clarify the plan as presented at the February 24, 1988 Public Hearing. Further, these conditions are intended to clarify the suitable arrangement and development for the presented plan.

1. The landscaped berm located closest to Mineola Pike and designated for future parking is to remain. The Committee believes that keeping this berm in place is necessary to provide adequate screening for the residential property along Mineola Pike.
2. Elevations and grades along Mineola Pike will be reviewed at Site Plan Review with emphasis on minimizing the slope in this area and providing adequate screening of the parking area from Mineola Pike.
3. Any change to the approved Concept Development Plan and supporting information as presented at the February 24, 1988 Public Hearing must be reviewed by the Planning Commission's Technical Committee to determine if it is a major or minor change. If the Committee determines any change to be major, a new Application and Public Hearing will be required.

*Carol Smith*

\_\_\_\_\_  
Carol Smith, Chairwoman

*Fred Burch*

\_\_\_\_\_  
Fred Burch

\_\_\_\_\_  
Larry Barnett

*Rector Jones*

\_\_\_\_\_  
Rector Jones

*Don McMillian*

\_\_\_\_\_  
Don McMillian

JS:kam

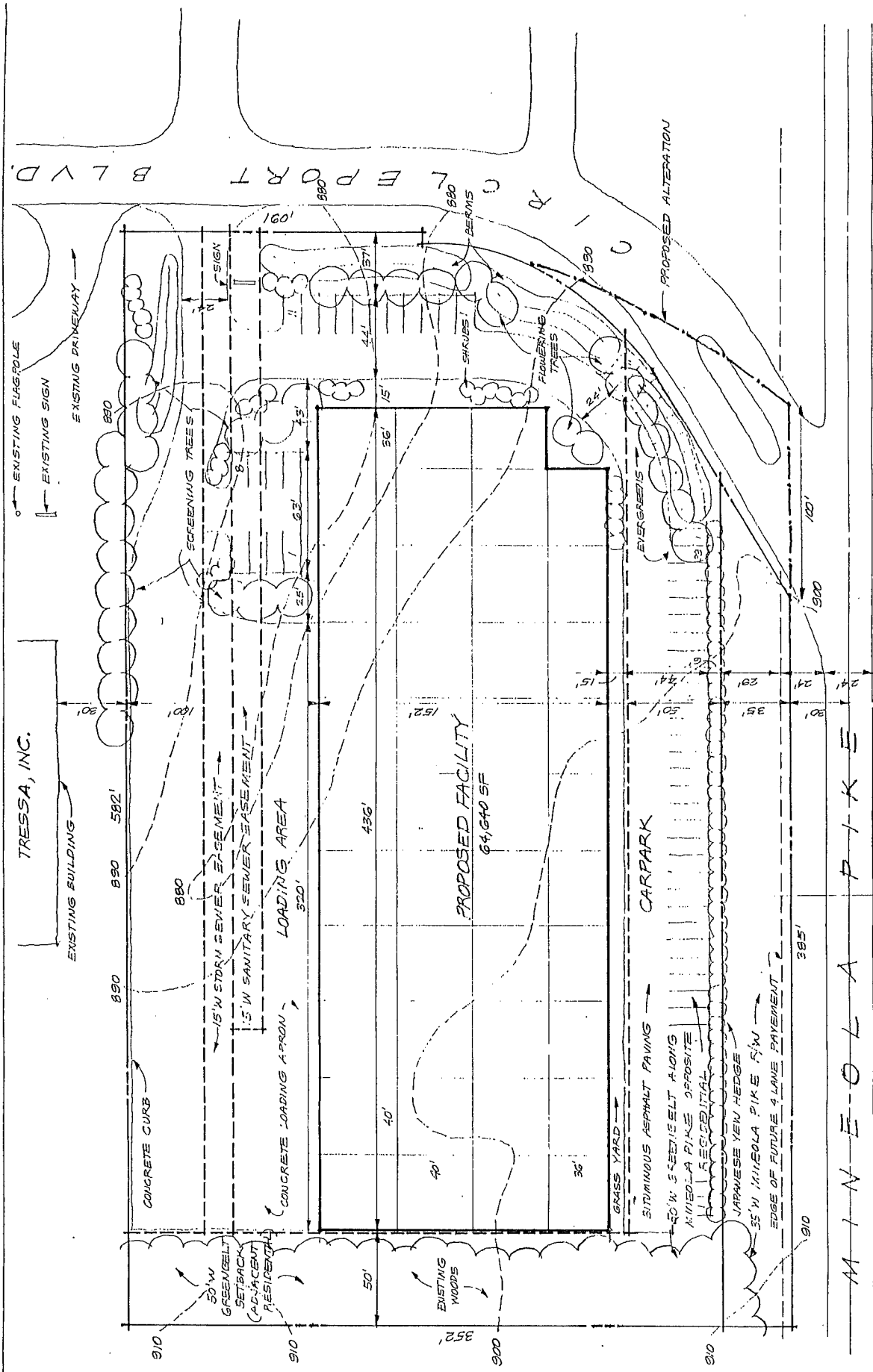

EXISTING FLAGPOLE  
 EXISTING SIGN  
 EXISTING DRIVEWAY

TRESSA, INC.  
 EXISTING BUILDING

SCREENING TREES  
 SHRUBS  
 BERRMS  
 FLOWERING TREES

CONCRETE CURB  
 15' W STORM SEWER EASEMENT  
 15' W SANITARY SEWER EASEMENT  
 CONCRETE LOADING APRON  
 LOADING AREA

PROPOSED ALTERATION

GRASS YARD  
 SIMULINOUS ASPHALT PAVING  
 CARPARK

PROPOSED FACILITY  
 64,640 SF

50' W SKEWELT ALONG MINEOLA PIKE OPPOSITE TO RESIDENTIAL  
 JAPANESE YEW HEDGE  
 35' W MINEOLA PIKE R/W  
 EDGE OF FUTURE 4 LANE PAVEMENT

EXISTING HOODS

30' W GREENBELT SETBACK (ADJACENT RESIDENTIAL)

910  
 900  
 890

910  
 900  
 890

910  
 900  
 890

910  
 900  
 890

ZONING: ZONED I-1  
 50' MAX. BLDG. HGT.  
 50' FRONT YARD  
 50' REAR SIDE YARD  
 10' SIDE YARD

SITE DATA: 4.60 ACRES  
 64,640 SF SERVICE BLDG  
 58 PARKING SPACES  
 11 FUTURE PARKING SPACES  
 100' X 520' LOADING DOCK  
 24' W ACCESS DRIVE  
 25' BLDG. EAVE HEIGHT  
 GAS, WATER, SEWER, ELECTRIC AVAIL.

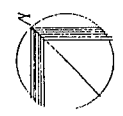

SITE PLAN 1" = 50'-0"  
 2090-P 22 JAN 88 ANH

MINEOLA PIKE

CLEPORT BLVD

ORDINANCE 920.144

AN ORDINANCE OF THE BOONE COUNTY FISCAL COURT ADOPTING A REVISION OF A PREVIOUSLY APPROVED CONCEPT DEVELOPMENT PLAN IN AN INDUSTRIAL ONE (I-1) ZONE ON A 4.3 ACRE TRACT LOCATED AT LOT 1, CIRCLE PORT I, OFF MINEOLA PIKE, BOONE COUNTY, KENTUCKY AS RECOMMENDED FOR APPROVAL BY THE BOONE COUNTY PLANNING & ZONING COMMISSION VIA RESOLUTION (R-16-88).

WHEREAS, the Boone County Planning Commission received a request for approval for a revision of a previously approved Concept Development Plan in an Industrial One (I-1) zone on a 4.3 acre tract located at Lot 1, Circleport I, off Mineola Pike, Boone County, Kentucky which is more particularly described below, and

WHEREAS, the Boone County Planning Commission as the planning unit for the unincorporated areas of Boone County was requested to and has conducted a Public Hearing serving as a due process trial-type hearing and made findings recommending approval for a revision of a previously approved Concept Development Plan in an Industrial One (I-1) zone on a 4.3 acre tract.

NOW, THEREFORE, BE IT RESOLVED BY THE BOONE COUNTY FISCAL COURT AS FOLLOWS:

SECTION I

That the revision of a previously approved Concept Development Plan for the real estate which is more particularly described below shall be and is hereby recommended for approval in an Industrial One (I-1) zone on a 4.3 acre tract. The real estate which is the subject of this request for approval for a revision of a previously approved concept Development Plan in an Industrial One (I-1) zone is more particularly described in attached "Exhibit A".

SECTION II

That as a basis for their recommendation of approval and adoption of the zone change request the findings of fact of the Boone County Planning and Zoning Commission as set forth in its Minutes and official records for this zone change request, and the finding of facts of the Boone County Fiscal Court, if any, and any conditions and/or stipulations mandated by the Boone County Fiscal court, if any, as set forth in its Minutes and official records for this zone change request, shall be and are hereby incorporated by reference as if fully set out in this Ordinance (Attached - EXHIBITS 'B' AND 'C').

ORDINANCE 920.144  
PAGE 2

That this ORDINANCE shall take effect and be in full force when passed, published and recorded according to law.

Introduced, seconded and given First Reading on the 22nd day of March, 1988.

Adopted by the Fiscal Court of Boone County after Second Reading at a regular meeting on the 19th day of April, 1988, and on the same occasion signed in open session by the County Judge/Executive as evidence of his approval, attested under seal by the Boone County Fiscal Court Clerk and declared to be in full force and effect.

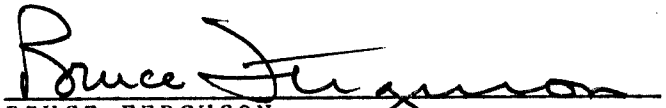
  
BRUCE FERGUSON  
BOONE COUNTY JUDGE/EXECUTIVE

ATTEST:

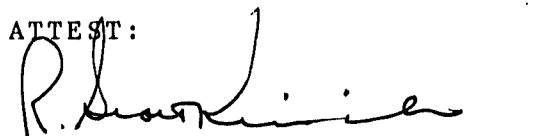
  
R. SCOTT KIMMICH  
FISCAL COURT CLERK

SUBMITTED BY:

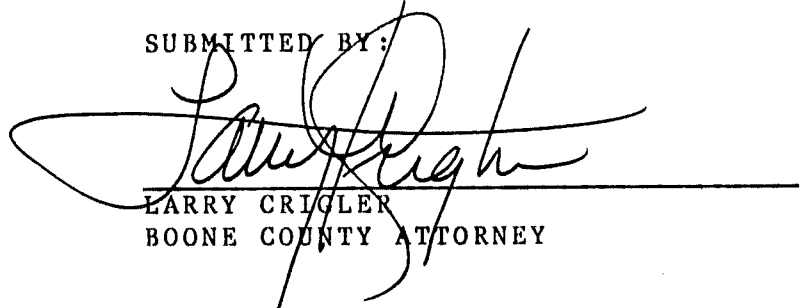
  
LARRY CRIGLER  
BOONE COUNTY ATTORNEY

\_\_\_\_\_  
DATE PUBLISHED